

# Delta Transducers

## Model : ARI753



## Features & Application

Appearance size, big span, special stainless steel sensor.

Suitable for all kinds of little space load, thread force monitoring,

Widely used in industry, research and development in the areas of measurement control.

## Mounting Dimension

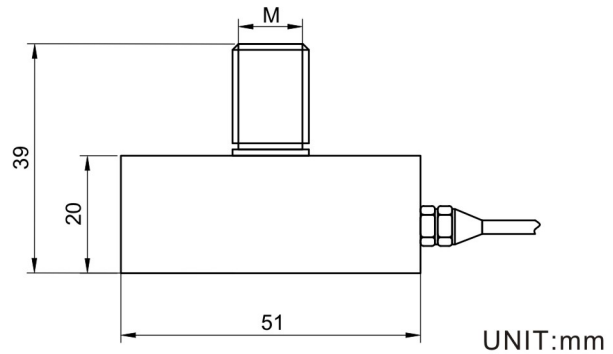
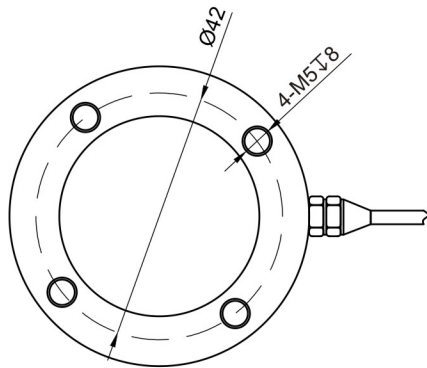

CAP	M
0.05T~2T	M12
2.5T~5T	M16

## Load Direction

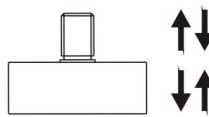

## Wiring

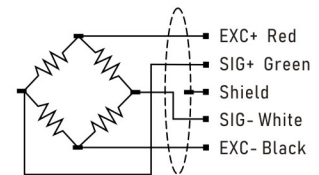

## Technical Parameters

Specifications	Technique
Rated load	0.05T~5T
Comprehensive error	$\leq \pm 0.1\%$
Non-linearity	0.1%
Rated output	$2.0 \pm 10\% \text{mV/V}$
Creep	$\pm 1\% \text{F.S.} / 30\text{min.}$
Zero balance	$\pm 2 \text{ F.S.}$
Input resistance	$750 \pm 5\Omega$
Output resistance	$700 \pm 5\Omega$
Insulation resistance	$\geq 5000\text{M}\Omega / 100\text{VDC}$
Temp.effect on span	$\pm 0.05\% \text{F.S.} / 10^\circ\text{C}$
Temp.effect on zero	$\pm 0.05\% \text{F.S.} / 10^\circ\text{C}$
Compensated temp range	$-10 \sim 60^\circ\text{C}$
Use temp range	$-20 \sim 80^\circ\text{C}$
Excitasion voltage	5~12V
Safe overload	150%F.S.
Ultimate overload	200%F.S.
Defend grade	IP66